

EXHAUST GAS HOSE FOR EXHAUST GAS TEMPERATURES UP TO +570°F

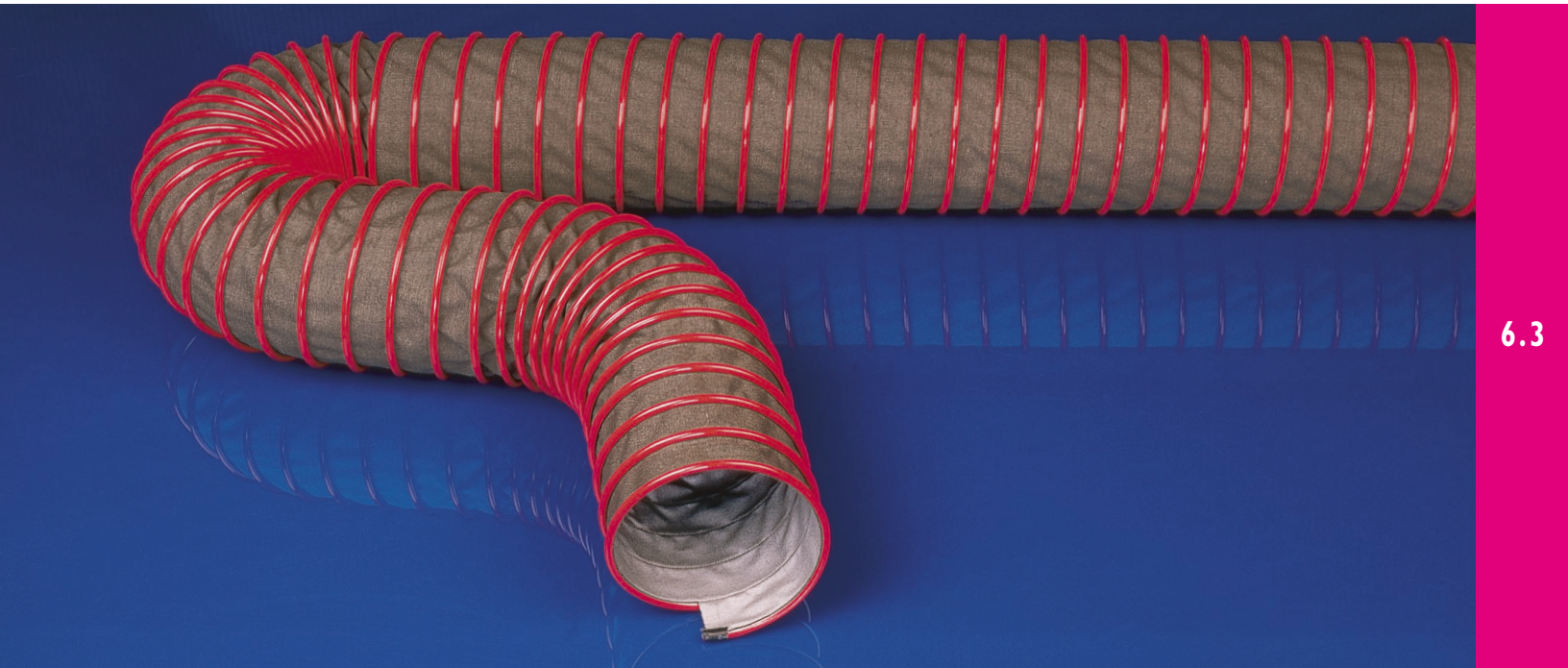

6.3

CARFLEX 570

Material

hose wall: special-coated high temperature fabric
external helix: galvanized steel with additional plastic abrasion protector

Applications

- high stress when extracting exhaust gas from spark ignition or diesel engines, especially suitable for trucks or construction machines
- suction extraction of engine exhaust gases up to +570°F when exhaust gas funnels are used properly
- all usual suction extraction systems such as:
 hose reel
 slotted channels
 abovefloor and underfloor suction extraction

Properties

- vibration resistant
- high resistance to mechanical loadings
- flame resistant
- extremely flexible
- compressibility 1:5
- small bend radius
- super lightweight
- extra strength
- abrasion-resistant
- special clamping method guarantees high tensile strength between hose material and external helix

Construction

- ① external helix
- ② additional abrasion protector
- ③ hose wall: special-coated high-temperature fabric

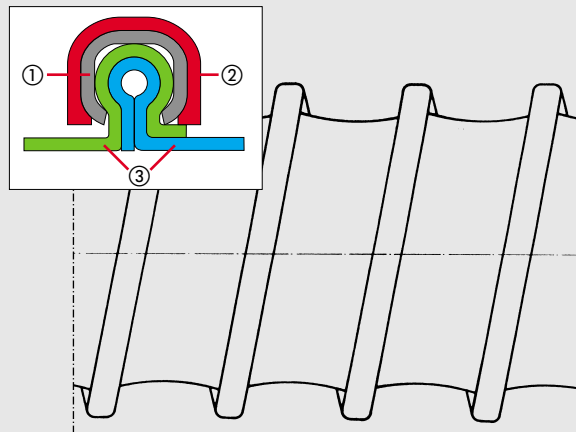

Temperature Range

- exhaust gas temperatures up to +570°F, short times up to +660°F when exhaust gas funnels are used properly and enough fresh air is utilized

Technical Data, custom designs and forms of delivery see back page



CARFLEX 570

Dia. (in.)	Outer (Dia.)	Negative (in. w.c.)	*Bending radius (in.)	Weight (lbs./ft.)	Product code
2.5	3.04	68	1.52	0.36905	241-063-119
3.0	3.56	56	1.84	0.32879	241-075-119
3.2	3.72	50	1.92	0.34221	241-080-119
4.0	4.68	32	2.40	0.42944	241-100-119
5.0	5.68	20	3.00	0.53009	241-125-119
6.0	6.68	14	3.60	1.16000	241-150-119
8.0	8.68	8	5.60	1.45000	241-200-119

* Referring to the inner side of the elbow of hose.

The above mentioned data refers to an average and ambient temperature of 68°F. Subject to technical changes and color variations. Please refer to technical data sheet when selecting hose.

Delivery forms:

Standard production:

- Dia. 2.5" - 8"
- Color:
 hose wall green-grey
 outer abrasion protector red
- Standard lengths 10', 25'

Available on request:

- special lengths
- special diameters from Dia. 2" - 20"
- fix lengths with mounted Clip-Grip-clamps
- abrasion protection profile in other colors
- custom design with other pitches and helix sizes

Installation and connection possibilities (see section no. 11 and 12):

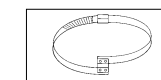

CLIP-GRIP special hose clamp for MASTER-CLIP hoses

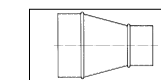

hose reducer, symmetrical

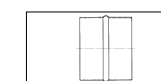

hose connector