

SUCTION AND TRANSPORT HOSE - MEDIUM WEIGHT

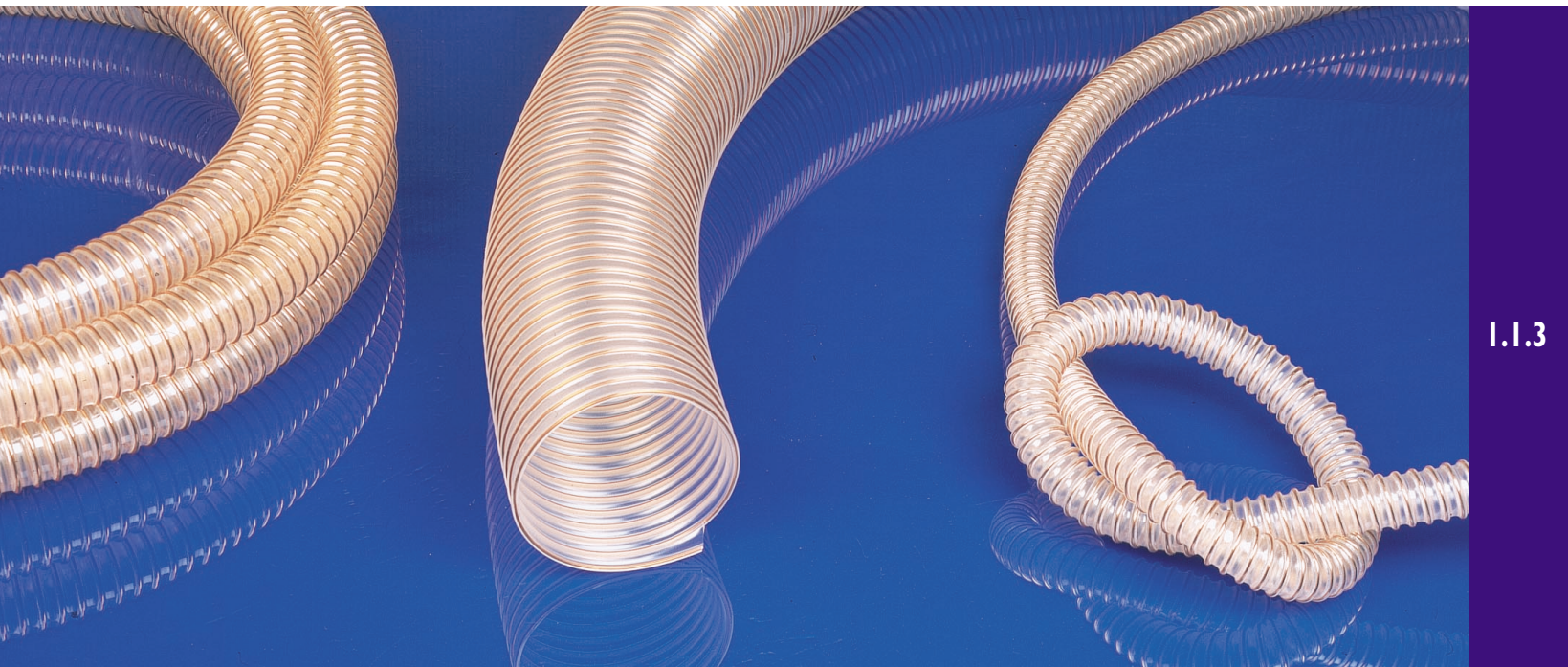

I.1.3

MASTER-PUR H

Material

hose wall: 100 % pure polyester polyurethane. 30% more abrasion-resistant than polyether polyurethane
spiral: PU-coated spring steel wire

Applications

- suction and transport hose for abrasive materials
- gaseous and liquid media
- suction of paper and textile fibers
- transport of small particled dusts and powders
- oil-spray extraction
- protection hose against mechanical pressure

Properties

- highly abrasion-resistant
- resistant to oil and fuels
- gas-tight
- good chemical resistance
- resistant to solvents
- free of plastisizers and halogens
- UV- and ozone-resistant
- very flexible; light weight
- small bend radius
- improved pressure and vacuum characteristics
- high tensile and burst strength
- smooth inside, for optimum flow characteristics
- electrically conductive by grounding spiral

Construction

- ① PU-coated spring steel spiral
- ② hose wall: polyester polyurethane
- ③ wall thickness between spirals .055"

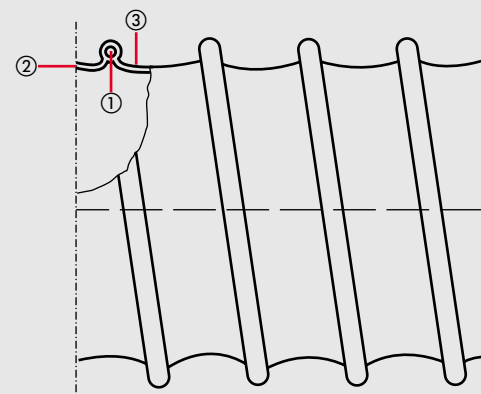

Temperature Range

- -40°F up to +195°F
- intermittent to +260°F

Chem. Resistance

see resistance table section no. 15

Technical Data, custom designs and forms of delivery see back page



MASTER-PUR H

Dia (in.)	Positive (in. w.c.)	Negative (in. w.c.)	*Bending radius (in.)	Outer Dia (in.)	Weight (lbs./ft.)	Product code
2.0	1,166	320	3.48	2.44	0.37576	313-050-401
2.4	1,025	300	4.08	2.80	0.44286	313-060-401
2.6	965	270	4.48	3.00	0.48312	313-065-401
2.8	904	270	4.68	3.20	0.51667	313-070-401
3.0	804	240	5.04	3.48	0.55022	313-075-401
3.2	804	240	5.28	3.64	0.58377	313-080-401
3.6	663	210	5.96	4.04	0.65087	313-090-401
4.0	603	180	6.60	4.48	0.72468	313-100-401
4.4	543	180	7.16	4.84	0.79178	313-110-401
4.6	543	125	7.44	5.04	0.82533	313-115-401
4.8	522	125	7.76	5.24	0.86559	313-120-401
5.0	522	125	8.12	5.52	0.89914	313-125-401
5.2	522	125	8.36	5.64	0.93269	313-130-401
5.6	422	100	8.96	6.04	1.04676	313-140-401
6.0	422	100	9.68	6.52	1.11386	313-150-401
6.4	362	100	10.20	6.84	1.18767	313-160-401
6.8	362	75	10.80	7.24	1.26148	313-170-401
7.0	362	75	11.12	7.44	1.29503	313-175-401
7.2	301	75	11.40	7.64	1.33529	313-180-401
8.0	301	75	12.84	8.60	1.91906	313-200-401
9.0	241	50	14.12	9.48	2.15391	313-225-401
10.0	241	50	15.60	10.52	2.38876	313-250-401
11.0	181	50	17.04	11.52	2.62361	313-275-401
11.0	181	50	17.40	11.72	2.67058	313-280-401
12.0	181	50	18.60	12.52	2.85846	313-300-401
12.6	181	50	19.52	13.12	2.99937	313-315-401
13.0	181	50	20.12	13.52	3.09331	313-325-401
14.0	181	50	21.60	14.52	3.32816	313-350-401
16.0	121	27	24.60	16.52	3.79786	313-400-401

* Referring to the inner side of the elbow of hose.

The above mentioned data refers to an average and ambient temperature of 68°F. Subject to technical changes and color variations. Please refer to technical data sheet when selecting hose.

Installation and connection possibilities (see register no. 11 and 12):

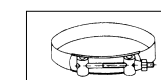

hose clamp with round pins

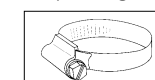

hose clamp with worm wheel drive

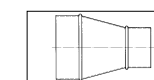

hose reducer, symmetrical

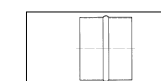

hose connector