

FILM HOSE - LIGHTWEIGHT, VERY FLEXIBLE AND COMPRESSIBLE

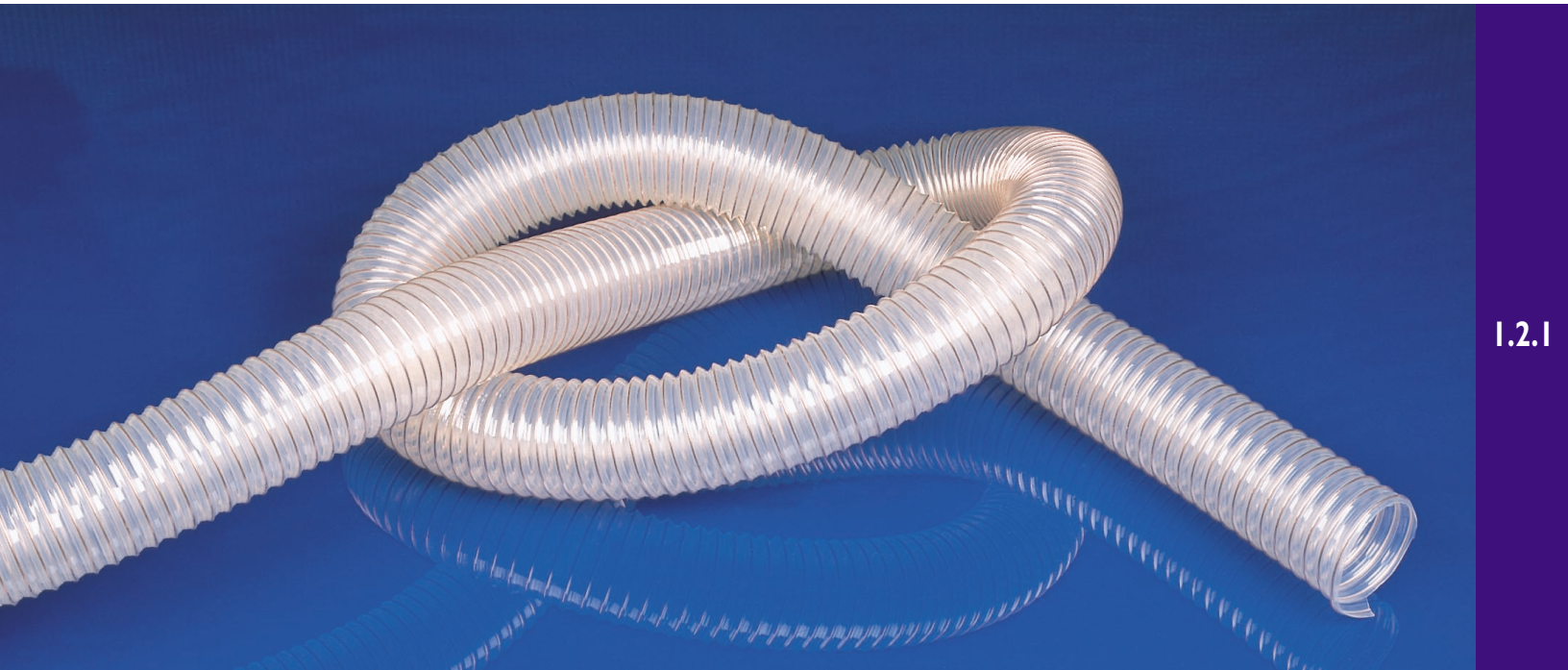

1.2.1

FLAMEX SL

Material

hose wall: 100 % pure polyester polyurethane with addition of flame protection. 30% more abrasion-resistant than polyether polyurethane

spiral: PU-coated spring steel wire

Applications

- transport hose for abrasive solids in fire risk areas
- woodworking machines
- exhaust equipment in wood-working industries
- protection hose against mechanical pressure

Properties

- conforms to the requirements of the German Professional Woodworking Association
- flame resistant
- reinforced by spring steel spiral
- extremely flexible
- small bend radius
- high tensile and burst strength
- super lightweight
- highly abrasion-resistant
- kink-proof
- compressible down to 20%
- solvents, oil and fuels-resistant
- gas-tight
- free of plastizisers and halogens
- UV- and ozone-resistant
- smooth inside, for optimum flow characteristics
- electrically conductive by grounding spiral

Construction

- ① PU-coated spring steel spiral
- ② hose wall: polyester polyurethane
- ③ wall thickness between spirals .02"

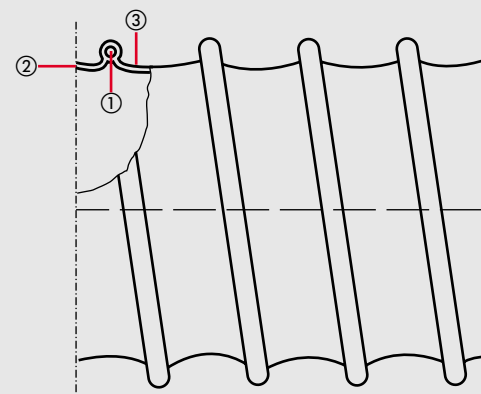

Temperature Range

- -40 °F up to +195 °F
- intermittent to +260 °F

Chem. Resistance

see resistance table section no. 15

Technical Data, custom designs and forms of delivery see back page



FLAMEX SL

Dia (in.)	Positive (in. w.c.)	Negative (in. w.c.)	*Bending radius (in.)	Outer Dia (in.)	Weight (lbs./ft.)	Product code
2.40	305	76	1.40	2.72	0.22143	321-060-601
2.52	289	70	1.48	2.84	0.22814	321-063-601
2.60	273	64	1.52	2.92	0.24156	321-065-601
2.80	245	64	1.60	3.12	0.25498	321-070-601
3.00	245	52	1.72	3.32	0.33550	321-075-601
3.20	213	52	1.80	3.52	0.35563	321-080-601
3.60	185	38	2.00	3.96	0.39589	321-090-601
4.00	185	38	2.20	4.32	0.44286	321-100-601
4.40	153	38	2.40	4.76	0.48983	321-110-601
4.60	153	38	2.52	4.96	0.50996	321-115-601
4.80	153	38	2.60	5.16	0.53009	321-120-601
5.00	153	38	2.72	5.36	0.55693	321-125-601
5.20	121	38	2.80	5.56	0.57706	321-130-601
5.60	121	26	3.00	5.96	0.61732	321-140-601
6.00	121	26	3.20	6.36	0.66429	321-150-601
6.40	121	26	3.40	6.76	0.67100	321-160-601
6.80	92	26	3.60	7.16	0.71797	321-170-601
7.00	92	26	3.72	7.36	0.73810	321-175-601
7.20	92	26	3.80	7.56	0.75823	321-180-601
8.00	92	26	4.20	8.40	0.78507	321-200-601
9.00	60	12	4.72	9.40	0.80520	321-225-601
10.00	60	12	5.20	10.40	1.20109	321-250-601
11.00	60	12	5.72	11.40	1.32187	321-275-601
11.20	60	12	5.80	11.60	1.34871	321-280-601
12.00	56	11	6.20	12.40	1.44265	321-300-601
14.00	48	8	7.20	14.40	1.67750	321-350-601
16.00	40	5	8.20	16.40	1.91235	321-400-601

* Referring to the inner side of the elbow of hose.

The above mentioned data refers to an average and ambient temperature of 68°F. Subject to technical changes and color variations. Please refer to technical data sheet when selecting hose.

Installation and connection possibilities (see register no. 11 and 12):

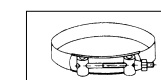

hose clamp with round pins

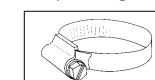

hose clamp with worm wheel drive

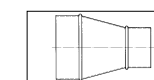

hose reducer, symmetrical

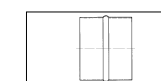

hose connector